

# VICTORIA AVENUE EAST CAMPUS STUDENT & VISITOR MAP



## SECOND FLOOR

See reverse side  
for 2nd floor map ↻

## THIRD FLOOR (Top Level)



## 1ST & 3RD FLOOR LEGEND

### STUDENT SERVICES

-  Admissions
-  Financial Aid & Awards Office
-  Lecture Theatre
-  Registrar's Office

### OFFICES

-  Athletics
-  Human Resources
-  IT Services
-  President's Office
-  School of Health & Human Services
-  School of Nursing

### BUILDING AMENITIES

-  Elevator
-  Stairs
-  Ramp (gym access)
-  Gender-inclusive washroom
-  Men's washroom
-  Women's washroom

### EMERGENCY SERVICES

-  Emergency Exit

# VICTORIA AVENUE EAST CAMPUS

## STUDENT & VISITOR MAP



### SECOND FLOOR (Main Floor)

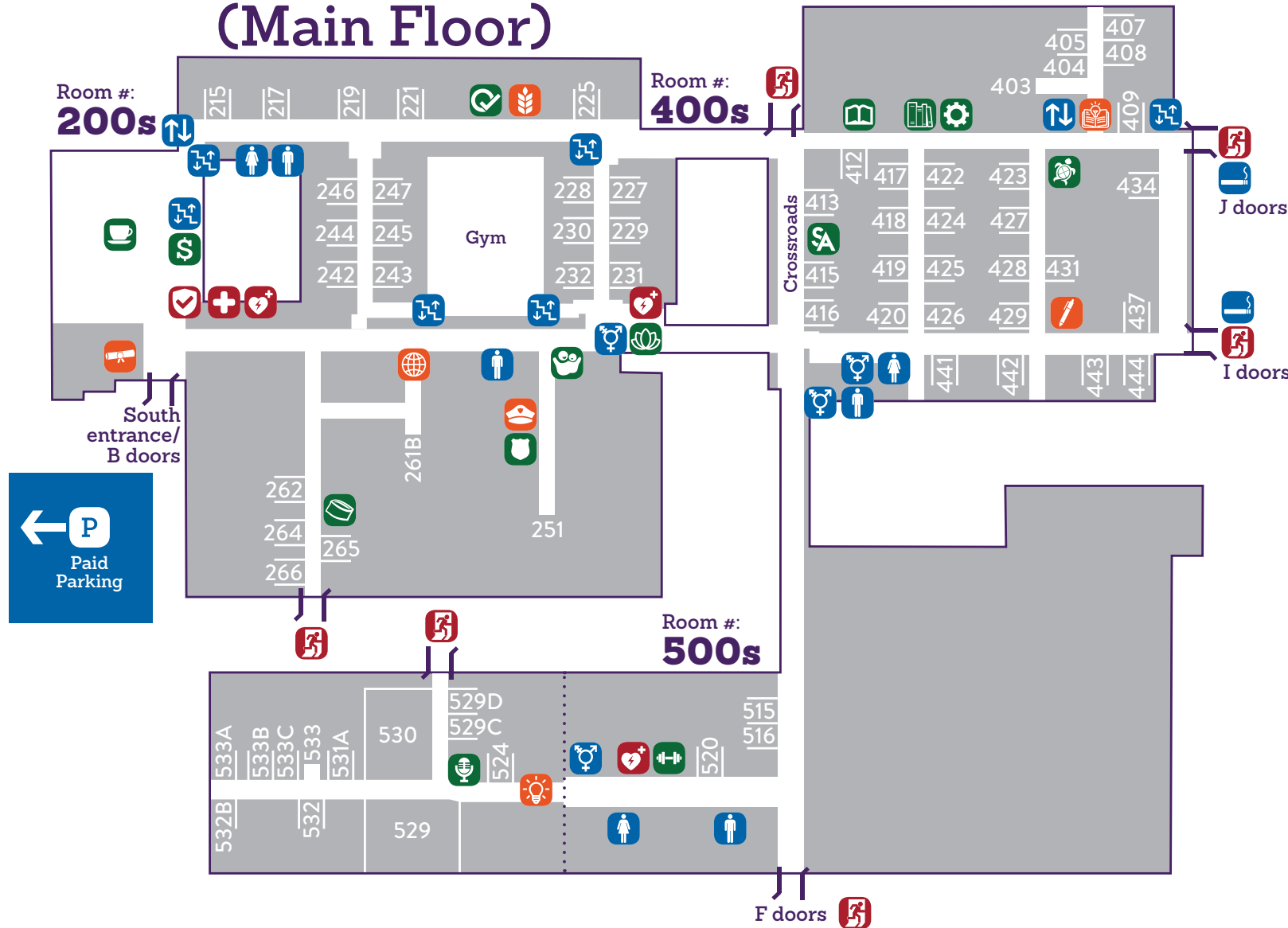

### 2ND FLOOR LEGEND

#### STUDENT SERVICES

- ATM
- Bookstore
- Cafeteria
- CJ106 Radio Station
- Indigenous Student Cultural Centre
- Early Learning Centre
- Fitness Centre
- Learning Curve
- Library
- Prayer & Relaxation Room
- Public Safety Training Centre
- Students' Association
- Test Centre
- The Protein Pantry

#### OFFICES

- Assiniboine International
- Centre for Adult Learning
- Centre for Creative Media
- Continuing Studies
- Public Safety Office
- School of Agriculture & Environment
- School of Business

#### BUILDING AMENITIES

- Designated smoking area
- Elevator
- Stairs
- Gender-inclusive washroom
- Men's washroom
- Women's washroom

#### EMERGENCY SERVICES

- Defibrillator
- Emergency Exit
- First Aid
- Security